

KADASTRAAL PLAN

De AAPD is de auteur van het kadastraal perceelplan en de producent van de databank waarin deze gegevens zijn opgenomen en geniet de intellectuele eigendomsrechten opgenomen in de Auteurswet en de Databankenwet.

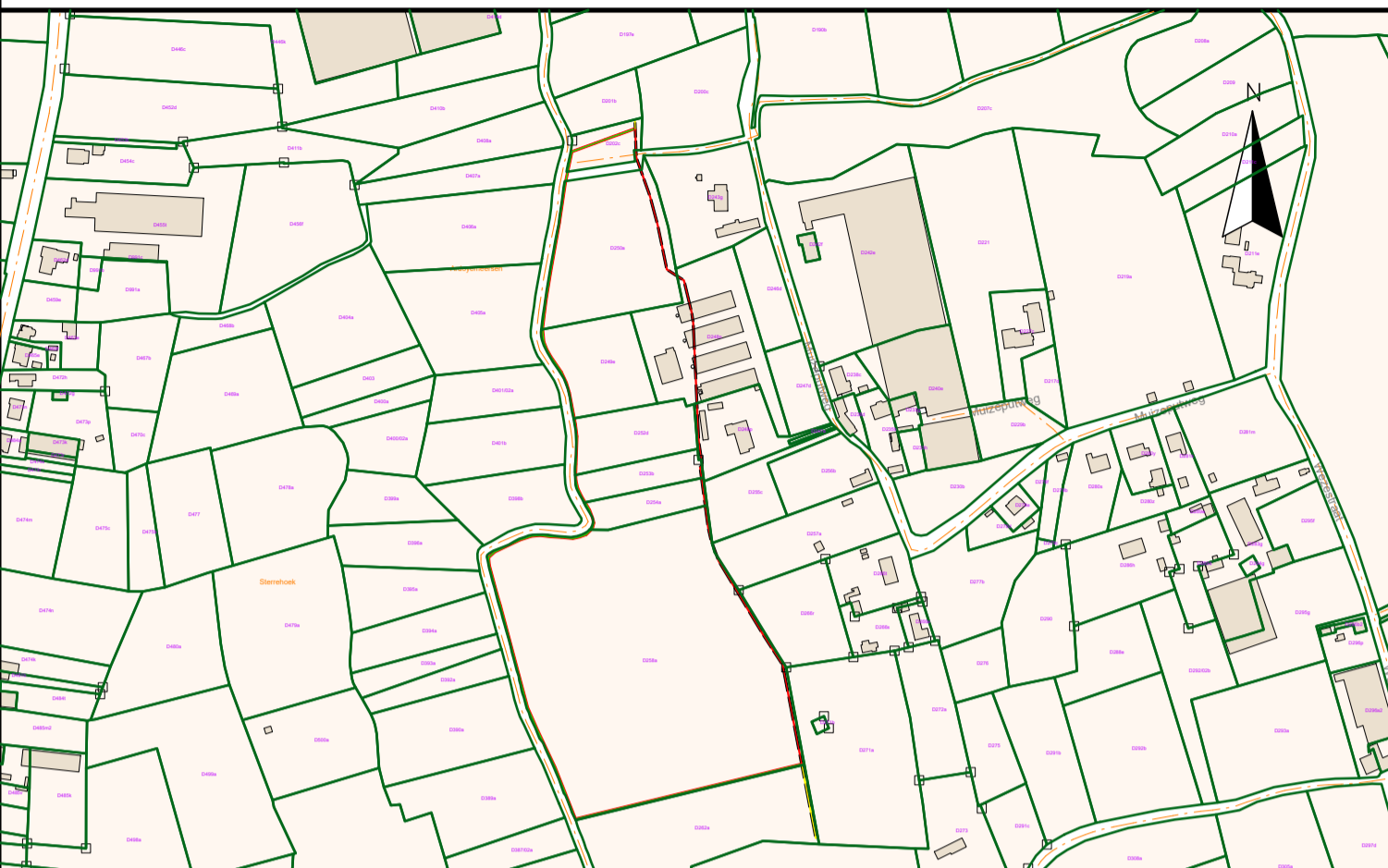

Coördinatenlijst (Lambert 72)

Nr.	X	Y
1	68076.86	184703.79
2	68085.39	184706.89
3	68092.34	184709.45
4	68098.49	184711.76
5	68103.06	184713.32
6	68063.68	184677.94
7	68059.44	184649.48
8	68053.27	184614.80
9	68049.88	184593.99
10	68048.74	184585.32
11	68047.37	184573.71
12	68048.26	184563.98
13	68050.54	184558.40
14	68053.44	184553.12
15	68060.95	184542.14
16	68064.41	184534.68
17	68066.59	184527.37
18	68070.87	184505.03
19	68071.97	184496.43
20	68071.25	184476.62
21	68071.01	184468.76
22	68071.31	184464.61
23	68072.56	184459.12
24	68075.30	184453.36
25	68081.03	184443.56
26	68083.02	184438.29
27	68084.00	184434.67
28	68082.99	184430.94
29	68078.87	184426.93
30	68074.41	184425.31
31	68069.75	184424.30
32	68061.60	184425.05
33	68053.79	184425.55
34	68046.35	184426.37
35	68039.98	184425.85
36	68031.69	184423.16
37	68013.51	184414.50
38	68008.79	184410.22
39	68009.27	184404.33
40	68014.91	184383.16
41	68017.32	184375.13
42	68032.07	184319.75
43	68036.71	184302.31
44	68044.15	184285.39
45	68056.43	184259.45
46	68068.44	184700.73
47	68113.63	184717.19
48	68114.96	184722.23
64	68113.46	184722.18
80	68071.21	184221.91
81	68232.89	184261.16
82	68232.61	184262.64
83	68065.16	184677.67
84	68060.92	184649.24
85	68054.75	184614.54
86	68051.36	184593.77
87	68050.23	184585.13
88	68048.88	184573.69
89	68049.73	184564.34
90	68051.89	184559.05
91	68054.72	184553.91
92	68062.26	184542.89
93	68065.82	184535.21
94	68068.05	184527.73
95	68072.35	184505.27
96	68073.48	184496.50
97	68072.75	184476.57
98	68072.51	184468.79
99	68072.79	184464.84
100	68073.99	184459.62
101	68076.63	184454.06
102	68082.39	184444.21
103	68084.45	184438.75
104	68085.55	184434.67
105	68084.33	184430.15
106	68079.68	184425.63
107	68074.83	184423.86
108	68069.84	184422.79
109	68061.49	184423.55
110	68053.66	184424.05
111	68046.33	184424.87
112	68040.28	184424.37
113	68032.24	184421.76
114	68014.35	184413.24
115	68010.34	184409.60
116	68010.75	184404.59
117	68016.35	184383.56
118	68018.76	184375.54
119	68033.52	184320.14
120	68038.12	184302.81
121	68045.52	184286.01
122	68057.81	184260.05
123	68072.13	184223.68
124	68115.17	184716.16
125	68103.56	184711.91
126	68099.00	184710.34
127	68092.87	184708.04
128	68085.90	184705.49
129	68077.37	184702.38
130	68113.69	184715.61
131	68069.74	184699.61
132	68234.07	184262.99
133	68238.23	184233.30
134	68239.69	184233.65

Nieuwe voetweg

Beginpunt	Eindpunt	Lengte
86	87	8.71
87	88	11.52
88	89	9.39
89	90	5.71
90	91	5.86
91	92	13.36
92	93	8.46
93	94	7.81
94	95	22.87
95	96	8.84
96	97	19.94
97	98	7.79
98	99	3.96
99	100	5.36
100	101	6.15
101	102	11.41
102	103	5.84
103	104	4.23
104	105	4.67
105	106	6.49
106	107	5.16
107	108	5.11
108	109	8.39
109	110	7.84
110	111	7.38
111	112	6.07
112	113	8.44
113	114	19.82
114	115	5.42
115	116	5.03
116	117	21.76
117	118	8.38
118	119	57.33
119	120	17.93
120	121	18.35
121	122	28.73
122	123	39.09
123	124	7.41
124	125	6.57
125	126	4.83
126	127	11.26
127	128	8.96
128	129	10.78
129	130	4.83
130	131	6.55
131	132	7.42
132	133	9.08
133	134	8.12
134	135	1.58

Te behouden voetweg

Beginpunt	Eindpunt	Lengte
48	124	6.08
64	130	6.57
82	133	29.87
132	134	29.87

